



# Hot runner nozzle type 6SHF/6DHF with AHJ6

Open single nozzle with thick-film heating element (BlueFlow®) and heated adapter AHJ6

## TECHNICAL DATA

### 6SHF/6DHF

Melt channel Ød	6.0 mm					
Nozzle type	SHF – open with tip DHF – open with straight outlet					
Operating voltage	230 V <sub>AC</sub> *					
Nominal length of the nozzle (L) in mm	50	60	80	100	120	150
	■	■	■	■	■	□

### AHJ6

Melt channel Ød	6.0 mm				
Operating voltage	230 V <sub>AC</sub> *				
Adapter	straight (G)/radius (R)/ angle (W)				

Contact us for other nozzle lengths!

\*Volts alternating current  
 ■ available □ on request

## NOTE

Power connector CHF and thermocouple connector CMLK are to be ordered separately.

**BlueFlow® hot runner nozzle type SHF/DHF is not intended for sale or use in the USA or Canada!**



SHF – open nozzle with tip version "Tip" Antechamber version A

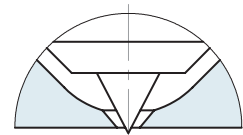

DHF – open nozzle with straight outlet version C Antechamber version A

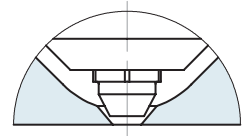

DHF – open nozzle with straight outlet version A Antechamber version C

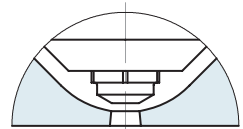



**INSTALLATION**

Open nozzle with tip  
Nozzle type version C  
Antechamber version A

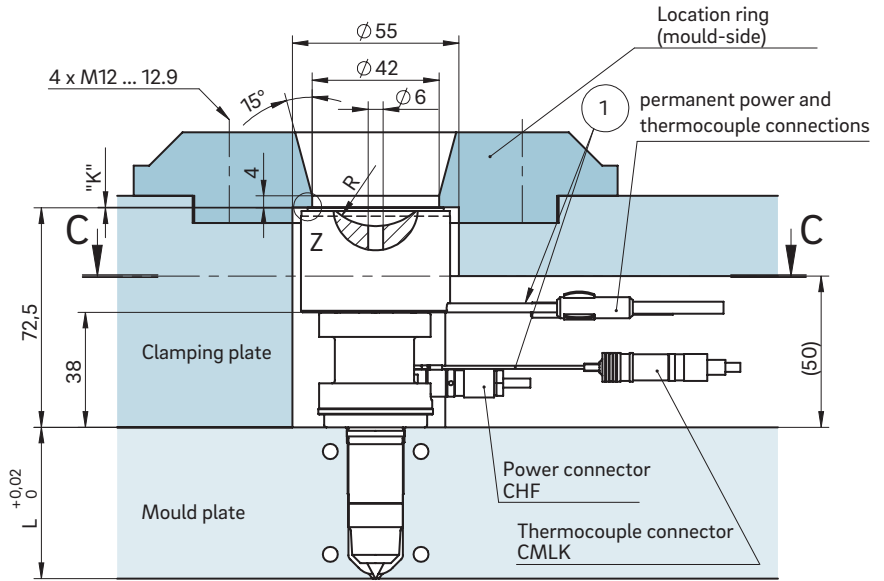
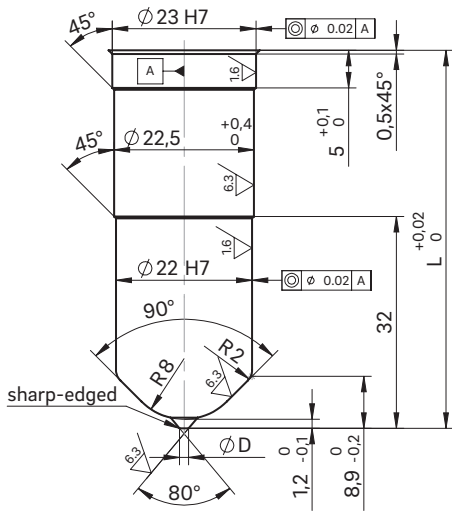

Cross-section C-C: Cutout for nozzle head, power and thermocouple plug connections

Open nozzle with straight outlet  
Nozzle type version A  
Antechamber version C

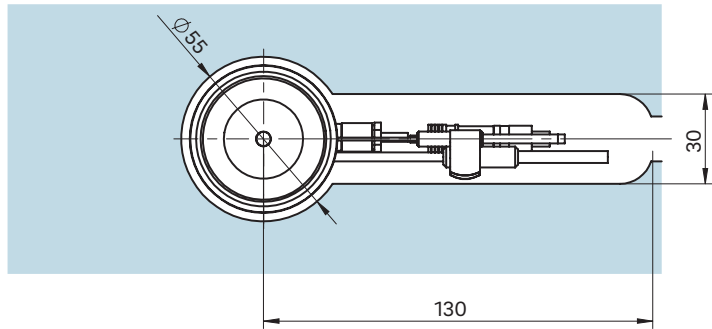
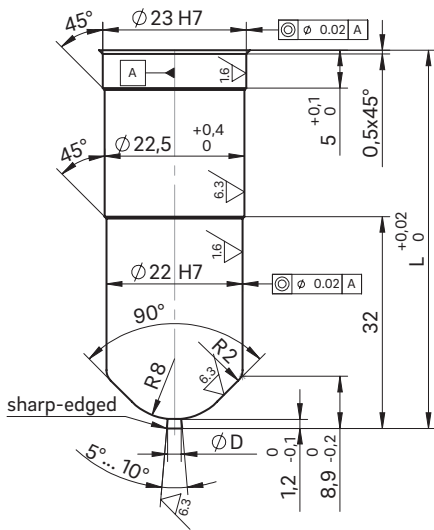

① Power and thermocouple plug connections in this area can be bent once; minimum radius: R8

Dimension "K" required for heat expansion is to be ensured by grinding the location ring! Determine the difference between the height of the nozzle (with mount) and the height of the structure when installed! ΔT specifies the temperature differential between the processing temperature and the mould temperature!

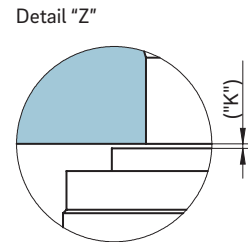

ΔT (°C)	100	150	200	250	300	350
K (mm)	0.06	0.08	0.09	0.11	0.13	0.16