



## Hot runner nozzle type 5SHT/5DHT

Open system nozzle with conventional heating element, screwed to the manifold

### TECHNICAL DATA

#### 5SHT/5DHT

Melt channel Ød	4.8 mm
Nozzle type	SHT – open with tip DHT – open with straight outlet
Operating voltage	230 V <sub>AC</sub> *

#### Nominal length of the nozzle (L) in mm

50	60	80	100
■	■	■	■

Contact us for other nozzle lengths!

\*Volts alternating current

■ available

### NOTE

Power connector CMT and thermocouple connector CMLK are to be ordered separately.



SHT – open nozzle with tip  
version "Tip"  
Antechamber version A

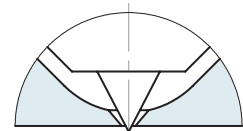

DHT – open nozzle with straight outlet  
version C  
Antechamber version A

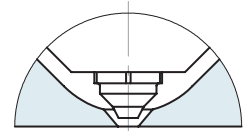

DHT – open nozzle with straight outlet  
version A  
Antechamber version C

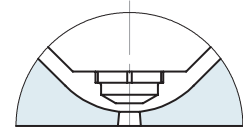

WEBCODE  
22040



**INSTALLATION**

Open nozzle with tip  
Nozzle type version C  
Antechamber version A

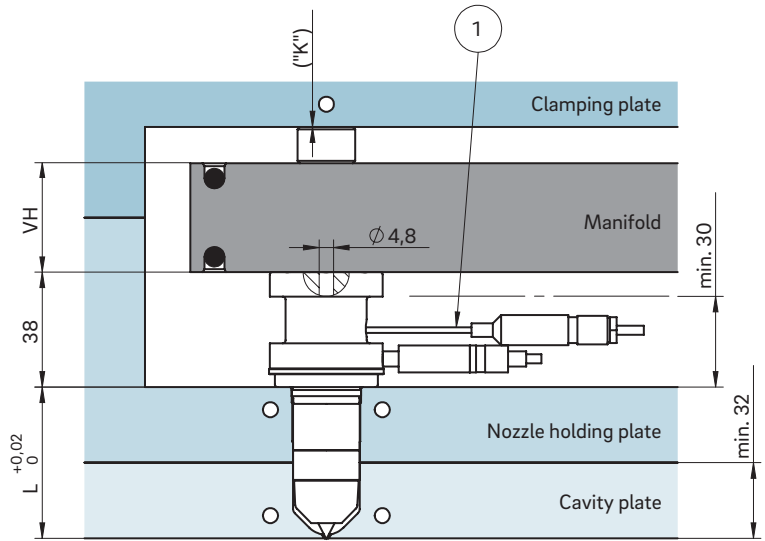
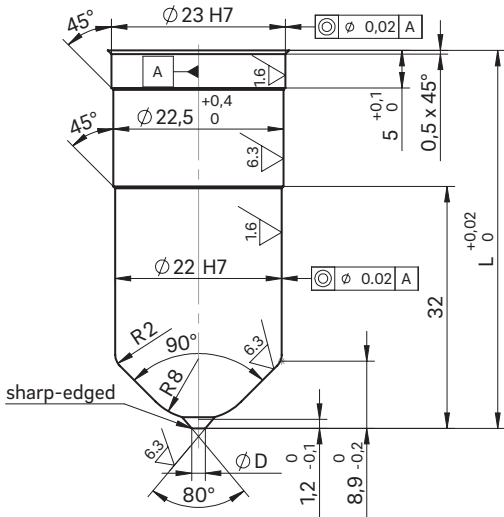

Example cutout for nozzle head, power and thermocouple plug connections

Open nozzle with straight outlet  
Nozzle type version A  
Antechamber version C

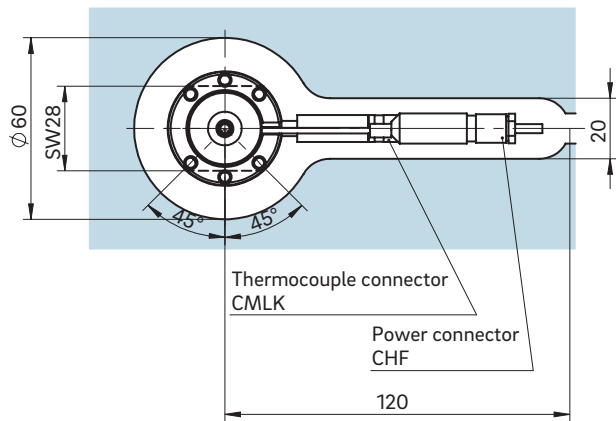
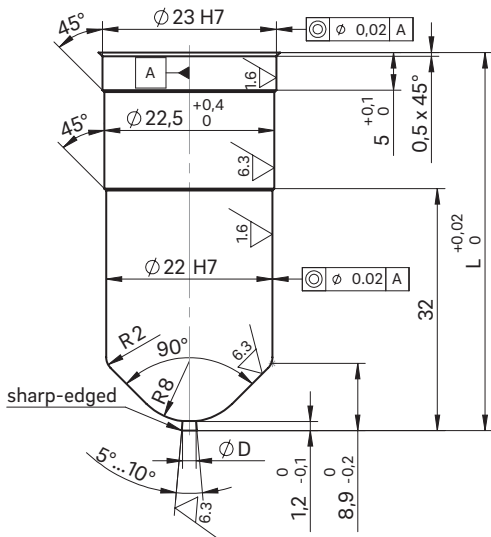

① Power plug connection in this area can only be bent once; minimum radius: R8  
SW = flat area on nozzle head

Dimension "K" required for heat expansion is to be ensured by grinding the pressure pad (12 + 0.1 mm)! Determine the difference between the height of the manifold system and the height of the clamping plate when installed! ΔT specifies the temperature differential between the processing temperature and the mould temperature!

VH	ΔT (°C)	100	150	200	250	300	350
36 mm	K (mm)	0.021	0.059	0.098	0.137	0.177	0.217
46 mm	K (mm)	0.033	0.078	0.124	0.170	0.218	0.264
56 mm	K (mm)	0.046	0.097	0.150	0.203	0.258	0.311