



Hot runner nozzle type 3SMF-K/3DMF-K

Open system nozzle with thick-film heating element (BlueFlow®), not screwed to the manifold

TECHNICAL DATA

3SMF-K/3DMF-K

Melt channel Ød	2.8 mm
Nozzle type	SMF – open with tip DMF – open with straight outlet
Operating voltage	230 V _{AC} *
Nominal length of the nozzle (L): 30 mm	

*Volts alternating current

NOTE

Can **also** be used laterally.

BlueFlow® hot runner nozzle type SMF/DMF is not intended for sale or use in the USA or Canada!



SMF – open nozzle with tip version "Tip" Antechamber version A

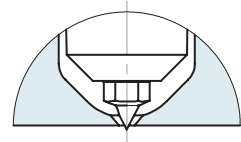

DMF – open nozzle with straight outlet version C Antechamber version A

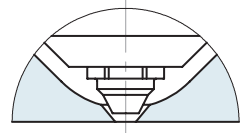

DMF – open nozzle with straight outlet version A Antechamber version C

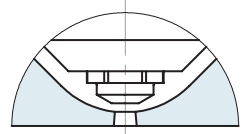



INSTALLATION

Open nozzle with tip
Nozzle type version C
Antechamber version A

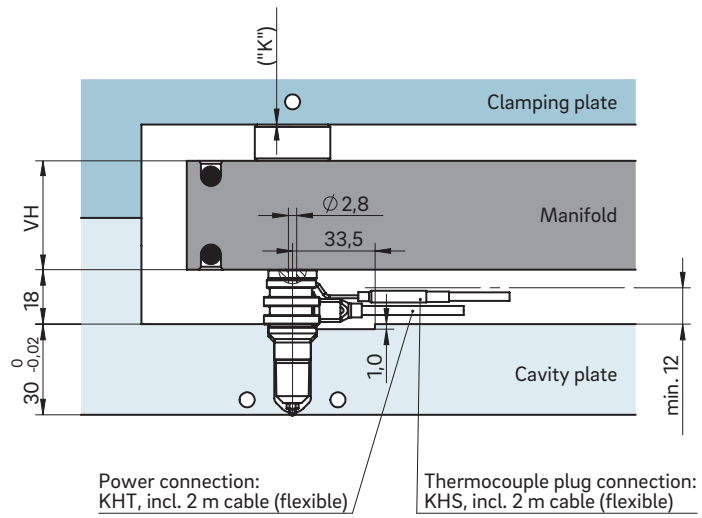
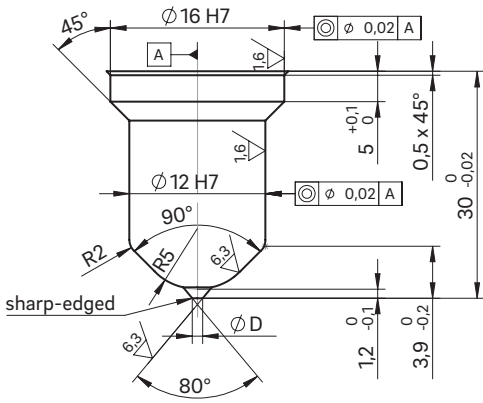

Open nozzle with straight outlet
Nozzle type version A
Antechamber version C

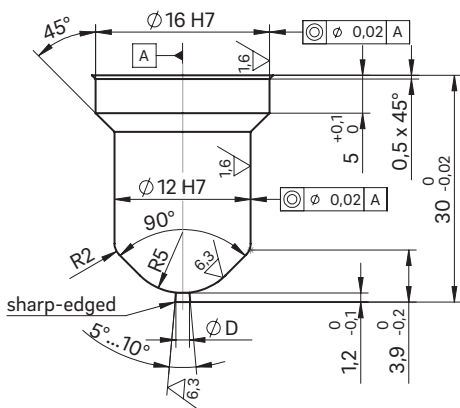

Example cutout for nozzle head, power and thermocouple plug connections

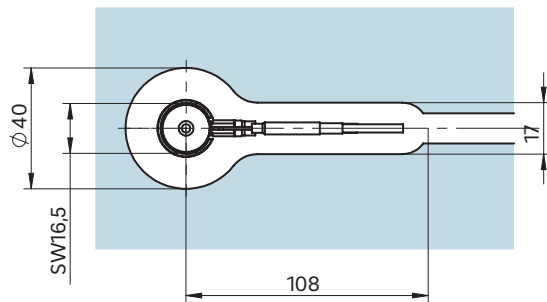

SW = flat area on nozzle head

Dimension "K" required for heat expansion is to be ensured by grinding the pressure pad (12 + 0.1 mm)! Determine the difference between the height of the manifold system and the height of the clamping plate when installed! ΔT specifies the temperature differential between the processing temperature and the mould temperature!

VH	ΔT (°C)	100	150	200	250	300	350
36 mm	K (mm)	0.021	0.059	0.098	0.137	0.177	0.217
46 mm	K (mm)	0.033	0.078	0.124	0.170	0.218	0.264
56 mm	K (mm)	0.046	0.097	0.150	0.203	0.258	0.311